

SIDE HINGES

SIDE HINGE

593



LH/RH

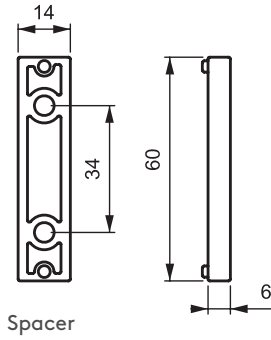

Spacer

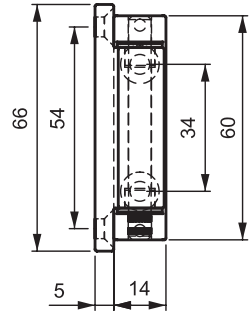

Standard version

- Spacer bar available for different dimensions
- Stainless steel hinge pin

APPLICATIONS

Electric panels, machinery covers

MATERIAL

Zamak DIN-EN 1774-ZnAl4Cu1
PIN: Stainless Steel

Spacer version
593 1-F-25

593 1-F-19

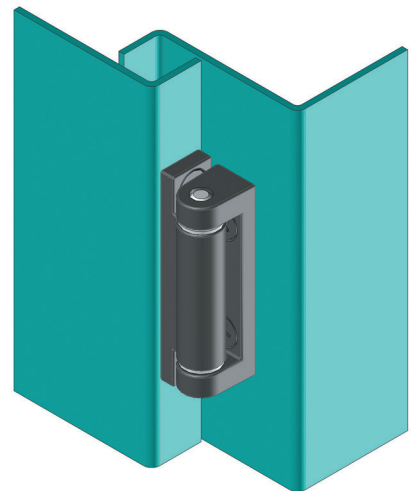
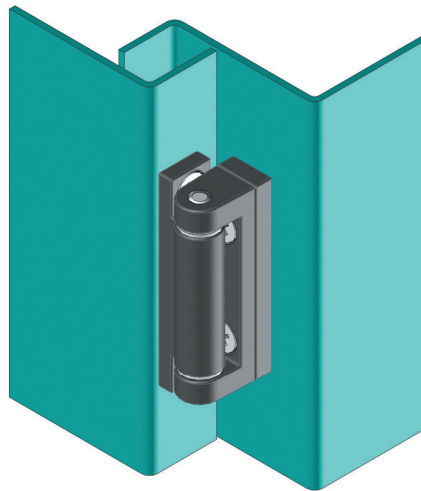
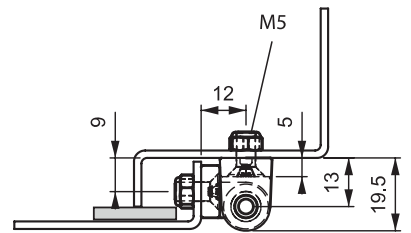
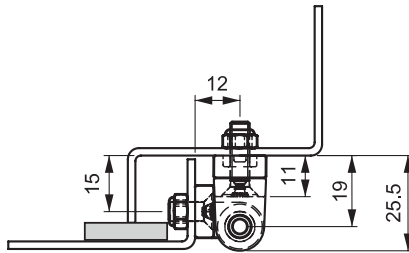

Hinge Rotation Angle



Note: Bolts are not supplied

PRODUCT CODE

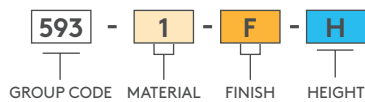

MATERIAL		FINISH	
	M		F
Zamak	1	Chrome	1
		Black coated	2