

THIS DRAWING IS UNPUBLISHED. RELEASED FOR PUBLICATION 20
 © COPYRIGHT 20 BY TYCO ELECTRONICS CORPORATION. ALL RIGHTS RESERVED.

| LOC | DIST | REVISIONS | | | | | |
|-----|------|-----------|-----|-------------------------|-----------|-----|------|
| | | P | LTR | DESCRIPTION | DATE | DWN | APVD |
| CE | 16 | | C | RELESE PER 0A00-0031-03 | 03FEB03 | KG | DW |
| | | | D | REVISE PER 0A00-0359-03 | 28OCT03 | KG | DW |
| | | | DI | ECR-09-003452 | 16FEB2009 | KG | DW |
| | | | E | ECR-09-007414 | 02JUN2009 | KG | DW |

- ALL DIMENSIONS ARE FOR REFERENCE ONLY.
- OPTIMIZED FOR 1550nm OPERATION IDENTIFIER.
- SINGLEMODE IDENTIFIER.
- PROTECTIVE LABEL APPLIED AFTER FINAL CLEAN ROOM TEST TO PREVENT OPTICAL CAVITY CONTAMINATION. REMOVE ONLY WHEN READY TO ASSEMBLE.
- USE WITH FERRULE ASSEMBLY KIT P/N 1515778-7 (125um), OR 1515895-1 (126um), OR 1588908-1 (SEALED 126um). FERRULE MUST BE PC-POLISHED DURING FIBER TERMINATION FOR BEST PERFORMANCE.
- THIS PRODUCT HAS NOT COMPLETED VALIDATION TESTING.

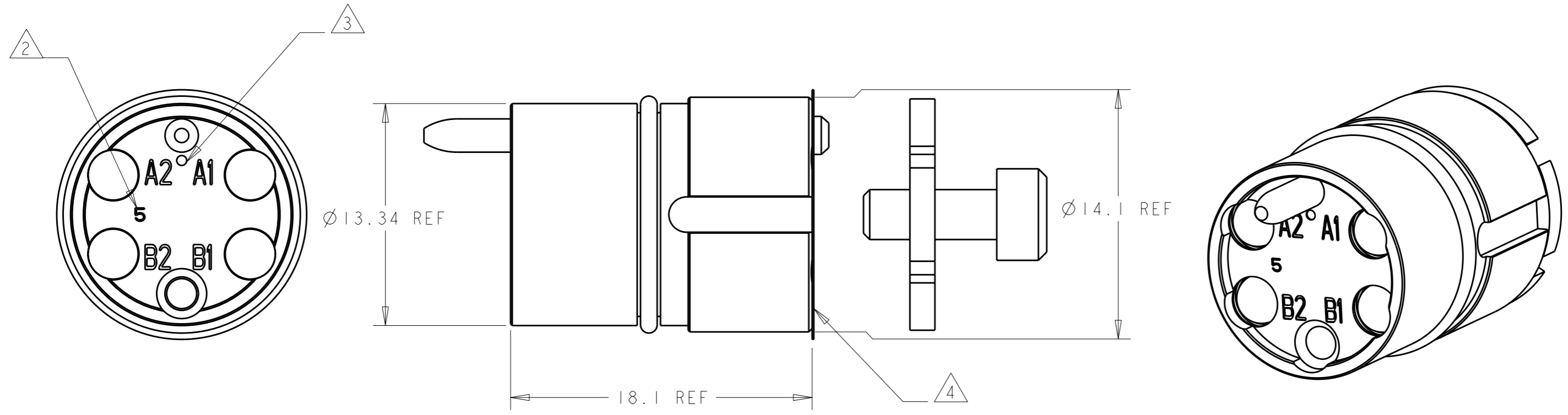

1516041-1
 PART NUMBER

| | | | | | |
|---|--|---|--|---|--|
| <small>THIS DRAWING IS A CONTROLLED DOCUMENT FOR TYCO ELECTRONICS CORPORATION IT IS SUBJECT TO CHANGE AND THE CONTROLLING ENGINEERING ORGANIZATION SHOULD BE CONTACTED FOR THE LATEST REVISION.</small> | | DWN 22 JAN 2003 K. GLATFELTER CHK 23 JAN 2003 D. WERTMAN APVD 31 JAN 2003 D. WERTMAN | | Tyco Electronics Harrisburg, PA 17105-3608 | |
| DIMENSIONS: mm | | TOLERANCES UNLESS OTHERWISE SPECIFIED: 0 PLC ±- 1 PLC ±- 2 PLC ±- 3 PLC ±- 4 PLC ±- ANGLES ±- | | NAME INSERT ASSEMBLY, PRO BEAM JR. 4 CHANNEL, 1550nm SM | |
| MATERIAL STAINLESS ALLOYS & NBR | | FINISH N/A | | PRODUCT SPEC - APPLICATION SPEC - WEIGHT - | |
| | | SIZE A3 CAGE CODE 00779 DRAWING NO C-1516041 | | RESTRICTED TO - | |
| | | CUSTOMER DRAWING | | SCALE 4:1 SHEET 1 OF 1 REV E | |