

SCALA NON IMPEGNATIVA
(DO NOT SCALE)
DIMENSIONI IN mm
(DIMENSIONS IN mm)

METRIC

THIRD ANGLE
PROJECTION

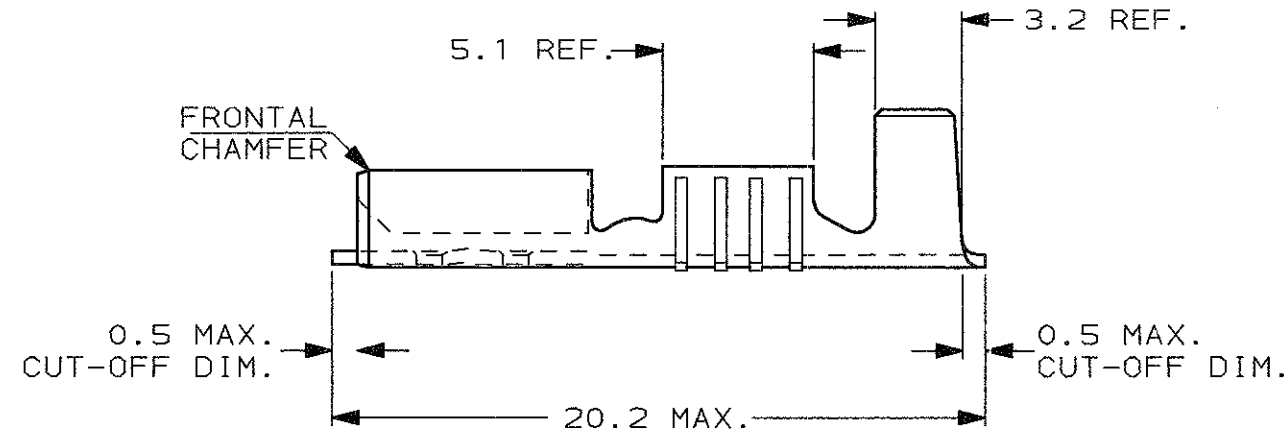
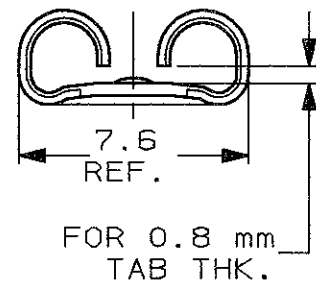
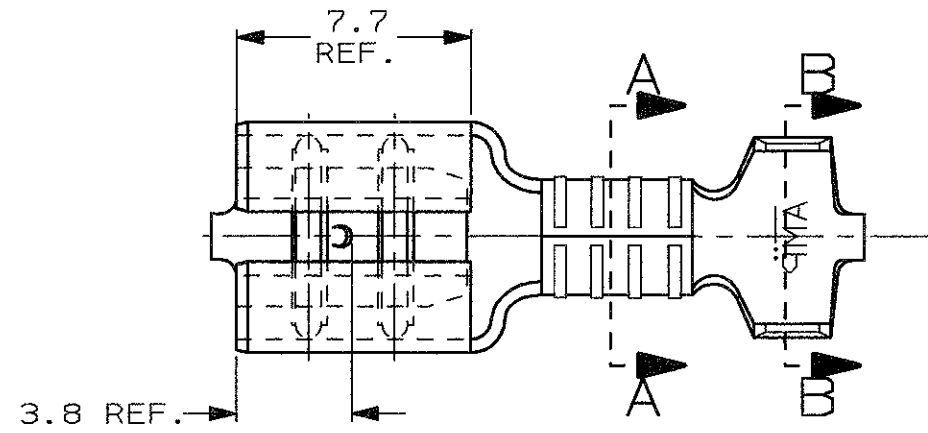

1) PER LE VERSIONI IN NASTRO
VEDERE DISEGNO 160256
(FOR STRIP FORM VERSION SEE DRAWING 160256)

SEZIONE A-A
SECTION A-A

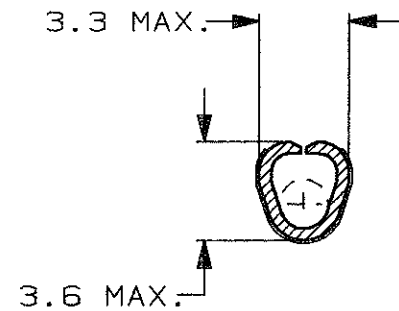

SEZIONE B-B
SECTION B-B

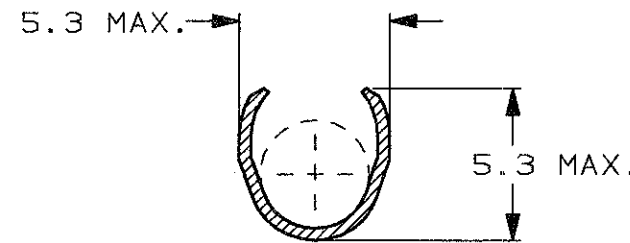

OBSOLETE

PRE NICHELATO (PRE NICKELPLATED)	ACCIAIO (STEEL)	2-160304-4	Y
STAGNATO (TIN PLATED)	BRONZO FOS. (PHOS. BRONZE)	1-160304-8	Y
ARGENTATO (SILVER PLATED)	OTTONE (BRASS)	1-160304-7	Y
NUDO (PLAIN)	BRONZO FOS. (PHOS. BRONZE)	1-160304-5	Y
STAGNATO (TIN PLATED)	OTTONE (BRASS)	1-160304-2	Y
NUDO (PLAIN)	OTTONE (BRASS)	1-160304-0	Y
FINITURA / COLORE (FINISH / COLOUR)	MATERIALE (MATERIAL)	NUMERO (PART NUMBER)	REV

CUSTOMER DWG. FOR REFERENCE ONLY **DISEGNO PER CLIENTE SOLO PER RIFERIMENTO**

THIS DRAWING IS UNPUBLISHED. RELEASE FOR PUBLICATION 19
© COPYRIGHT 19 BY TE INCORPORATED, HARRISBURG, PA. ALL INTERNATIONAL RIGHTS RESERVED. TE PRODUCTS MAY BE COVERED BY U.S. AND FOREIGN PATENT AND/OR PATENT PENDING

TOLLERANZE: SE NON DIVERSAMENTE SPECIFICATO (TOLERANCES, UNLESS OTHERWISE SPECIFIED)	DIAM. ISOLANTE (INS. DIA. RANGE)	RANGO FILO (WIRE RANGE) mm2	SCALA (SCALE)
± 0.3	3.0-4.3	1.0-2.5	4:1

ANGOLI (ANGLES) ± 2° **TE** TE Connectivity

DIS. H. YAALI (DR.) 15 SEP 2000 DESCRIZIONE (DESCRIPTION) FASTON® Connector, .250" sr. REC. CONTACT. (LOOSE PIECE VERSION)

Y1 ECR-10-022530	KK 02FEB11	CONT. C. TARTARI (CHK) 15 SEP 2000	LOC. SIZE NUMERO (DWG NO)	REV. FOGLIO (SHEET)
Y OBSOLETE PARTS & REDRAWN ET00-0246-00	H. Y. 02 JAN 2001	APP. (APP.)	I A3 C-160304	Y1 1 DI (OF) 1
REV. (REV.)	REVISIONI (REVISION RECORD)	DIS. DATA (DR) (DATE)		

DISTRIBUZIONE (PRINT DIST.)